

SMD ISOLATOR  
 [ P/N : IL05AL(R)1842ABE ]

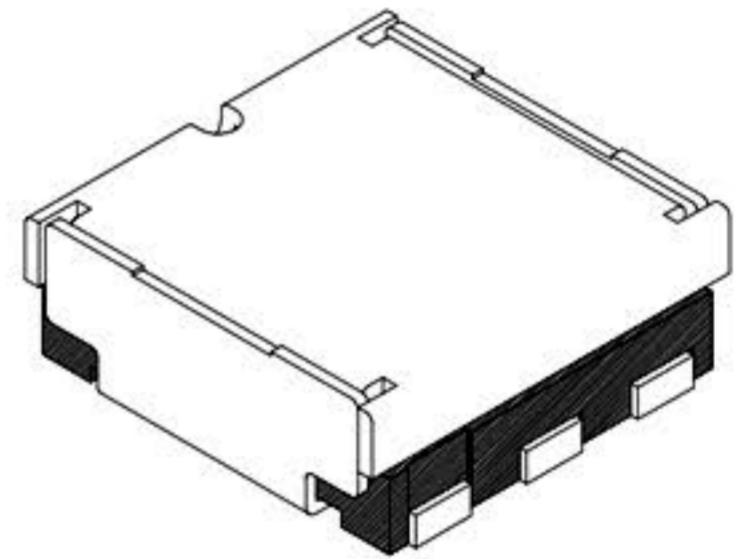

**P1,P2** : IN/OUT Port  
**G** : Ground  
**1842** : 1842.5MHz[fc]  
**●P01** :  
**●P01** L type [signal flow direction P1 → P2]  
**P01●** R type [signal flow direction P2 → P1]  
 [or left side dot is L type,  
 right side dot is R type]  
**0** Year [2010]  
**1** Month [January]  
 (Oct,Nov,Dec denoted as **O,N,D** )

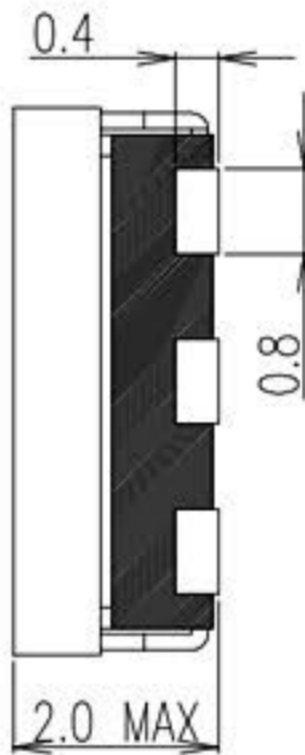
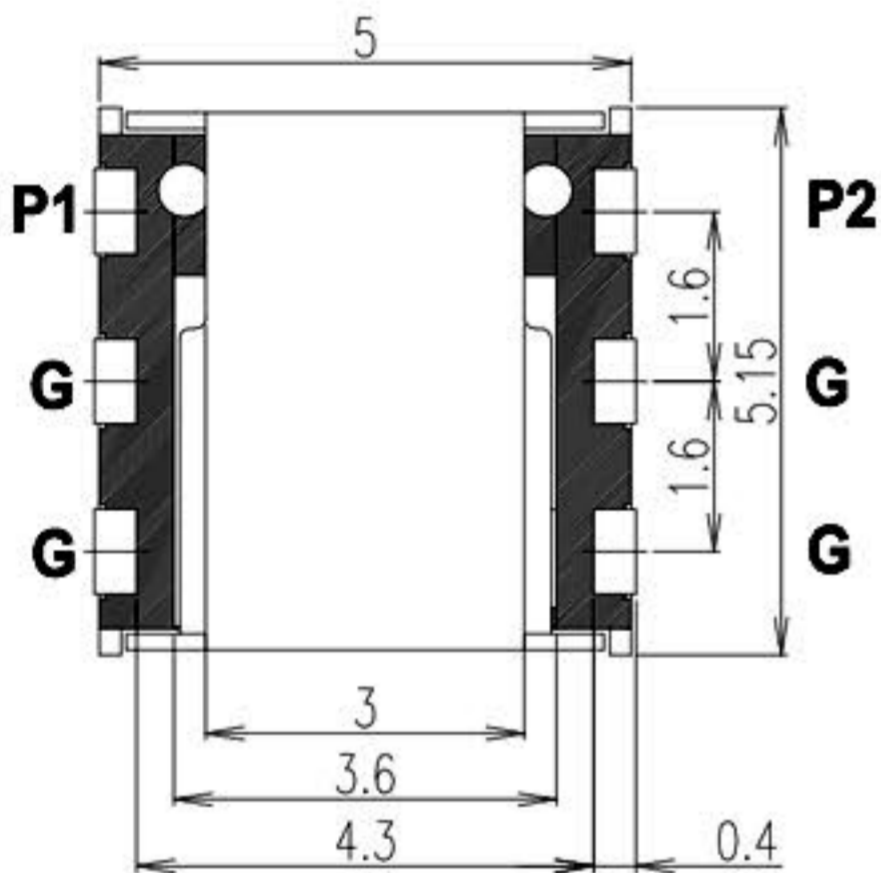

Scale : N/S  
 Unit : mm  
 Tolerance : ±0.2

ELECTRICAL SPECIFICATION	
Frequency Range	1805 ~ 1880 MHz
Operating Temp.	-35 ~ +85 °C
Insertion Loss	0.7 dB max.
Isolation	13 dB min.
VSWR	1.5 max.
Forward Power	10 W max.
Reverse Power	2 W max.

PART NUMBERING	
<b>IL 05 A L(R) 1842 AB E</b>	
IL	: Isolator Group
05	: Size [5*5*2.0t]
A	: Fabrication condition
L(R)	: Signal direction
1842	: Center frequency [1842.5MHz]
AB	: Fabrication condition
E	: Embossed plastic reel
* RoHS Compliant(Lead Free)	
- Ver 2.0 (2012.01.02.)	